

# Dalmaray Concrete Products Inc.

## Tank Model 2000/1000

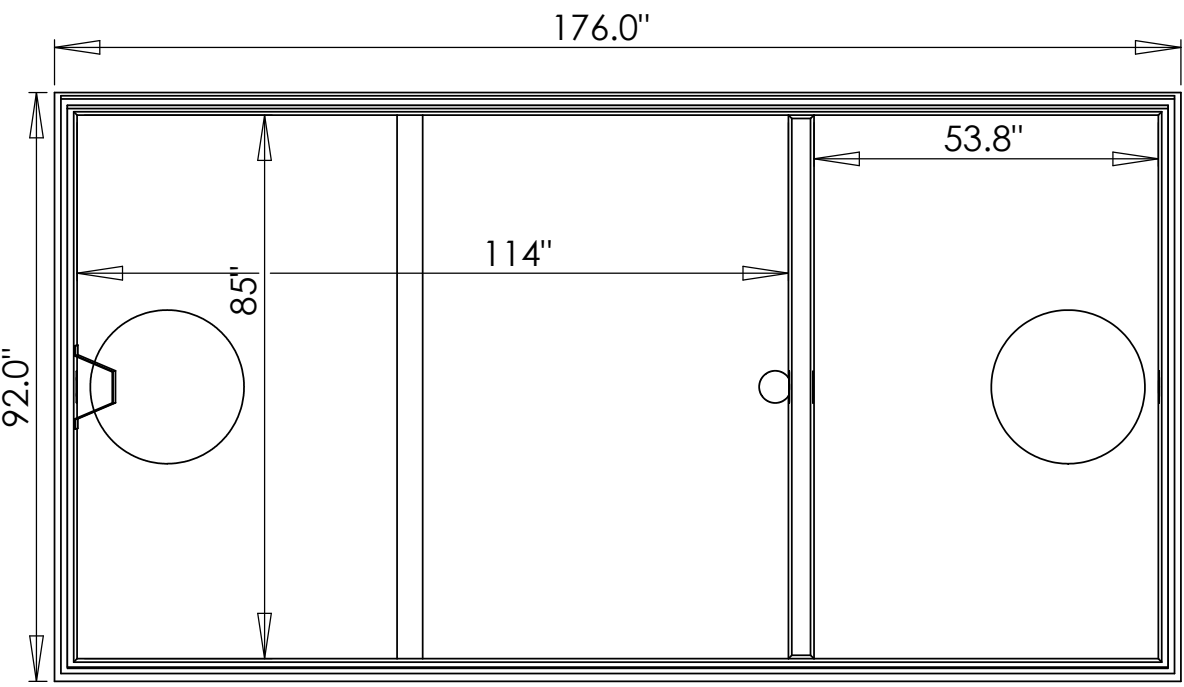

Model 2000/1000 Septic/Septic,  
 Septic/Pump, Septic/Siphon, Holding,  
 or Grease Interceptor

1530 GPD WHEN USED  
 AS A SEPTIC/SEPTIC TANK  
 1029 GPD WHEN USED  
 AS A SEPTIC/SIPHON TANK  
 BASED ON A 3 YR SERVICE INTERVAL

**DIMENSIONS:**

- LENGTH - 176"
- WIDTH - 92"
- HEIGHT - 71"
- BELOW INLET - 59"
- BOTTOM SECTION WEIGHT - 12500 lb.
- TOP SECTION WEIGHT - 12500 lb.
- MAX DEPTH OF BURY 108"

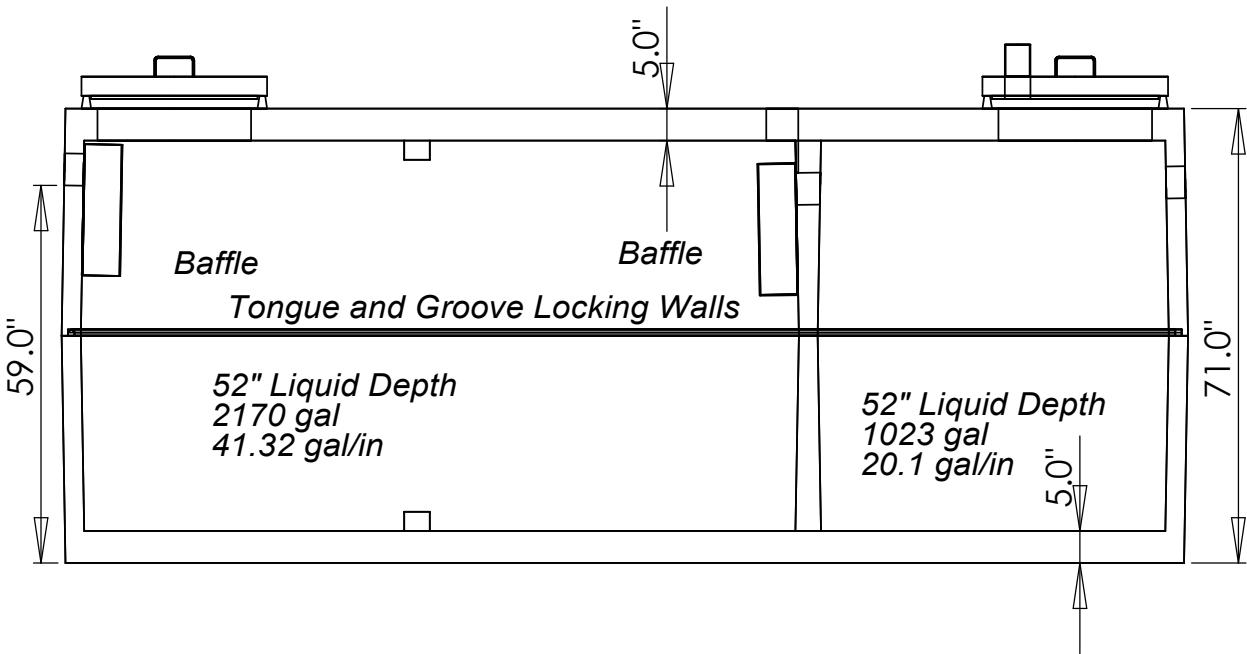

# Dalmaray Concrete Products Inc.

405 S. Arch St.  
 Janesville, WI 53548  
 (608)-752-6507  
 Toll Free: (888)-222-4541  
 Fax: (608)-752-5671